

Operating and installation instructions

Barriers-MAGSTOP MTS 6 / 8

1. Delivery

The Magstop barrier consists of:

- 1 Housing
- 2 Keys for the door (attached to the flange)
- 1 Documentation located inside the door

Accessories in separate box:

- 1 Foundation accessories C
- 2 Mounting rails (U Profile)
- 1 Boom Accessories B
- 1 Spare spring with steel sleeve

The Magstop barrier and the boom are delivered separately. Please check if the shipment is complete and in good condition. Any damages during transport should be the subject of a claim on the transport agency.

2. Foundation

To mount the barrier on the foundation and to lay the conduit, please refer to the enclosed information sheet MM 5115.

3. Housing

Fix the barrier to the foundation in accordance with figure 1 using accessories C. For final alignment of the housing the nuts only need to be tightened.

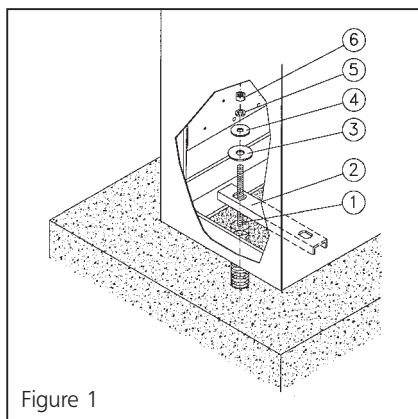

Figure 1

4. Installation of the barrier boom

4.1. Short barrier boom

Fix the barrier boom to the flange in accordance with figure 2 using accessories C. Afterwards align the barrier and tighten the nuts securing the housing to the foundation.

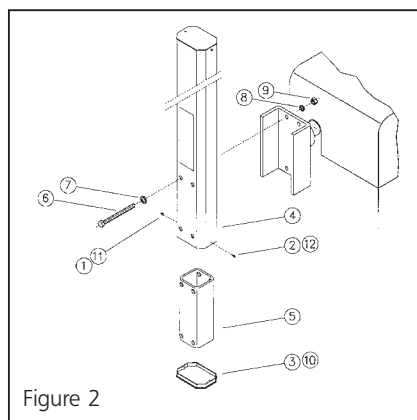

Figure 2

4.2. Long barrier boom

In order to facilitate the installation of a long boom the cover must be removed after having released the 3 T-bolts shown in figure 3.

To ease installation the flange can be moved to a horizontal position by releasing the 2 screws SW 10 at the upper lever (MTS8 has 4 screws and 2 levers); the barrier boom can then be fixed to the flange by using accessories D.

After having fixed the barrier boom raise it manually to the vertical position; for safety reasons the screws SW 10 are to be tightened to 125 Nm.

Afterwards align the barrier and tighten the nuts securing the housing to the foundation.

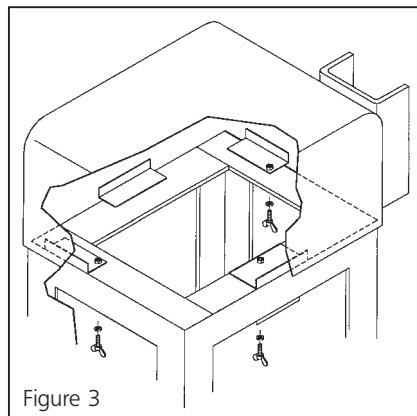

Figure 3

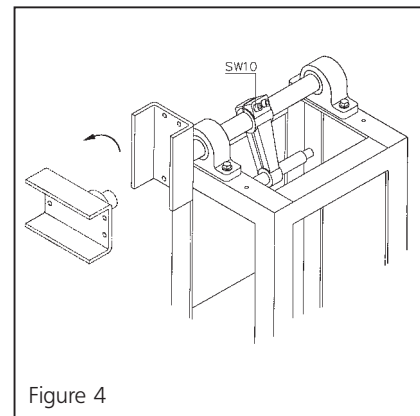

Figure 4

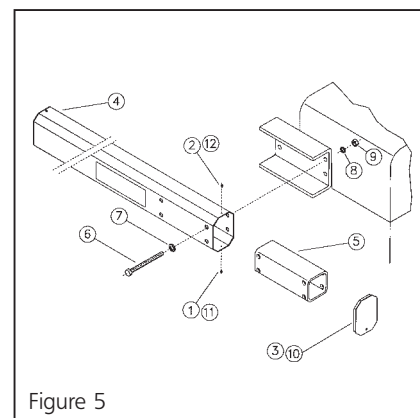

Figure 5

5. Electrical connections

Connection to the main electrical supply must be carried out by a qualified electrician. The wiring diagrams are in the documentation inside of the door.

Afterwards check that the installation operates correctly.

6. Adjustments

The barrier boom was adjusted to a horizontal closed end position and can be adjusted to local conditions, see paragraph 4.2.

7. Special applications

Should boom mounted stop signs, warning boards, lights etc. be required the springs must be re-adjusted due to the additional weight on the boom. The barrier boom is balanced with the motor de-energised at approximately 45 degrees.

If the existing springs are not sufficient for correct operation an additional spring must be fixed.

8. Pendulum support

For boom lengths exceeding 3500 mm a pendulum support is required which is to be mounted as shown in figure 6 and is fixed by 2 screws (M6/SW4) such that the narrow part of the mounting flange points towards the end of the boom.

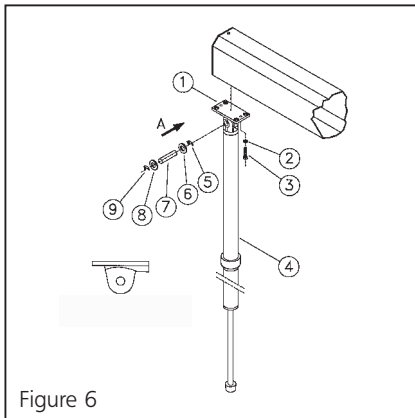

Figure 6

9. Lever adjustment

When the barrier boom is in the horizontal position, and the motor is supplied with power, the level system can be adjusted correctly if the barrier is locked (A). If the barrier is in the locked position (A).

There the connection bars (B) and the motor levers (C) are in the aligned position. The motor is supplied with power, but its power consumption is reduced (torque).

In the event of power failure, the motor lever is forced out of the dead center position by springs in the system, and the barrier may be operated by hand by applying sufficient pressure to the barrier boom.

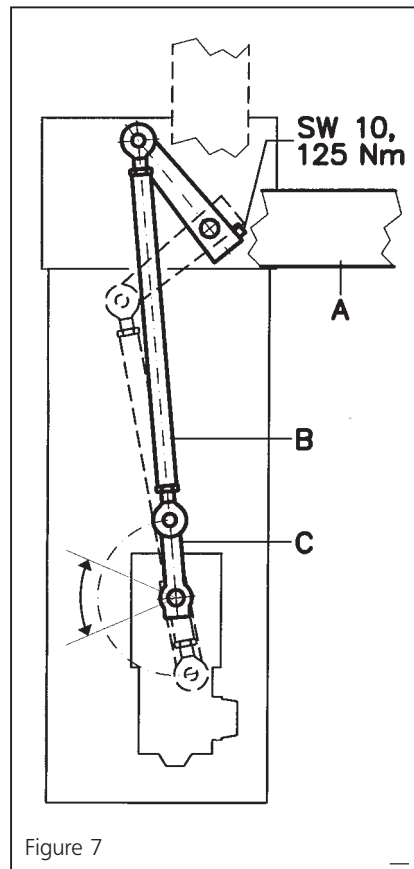

Figure 7