

Ersatzteilzeichnung  
 spare-parts  
 dessin pour pièces  
 détachées

MIB20L-A100

MIB20R-A100

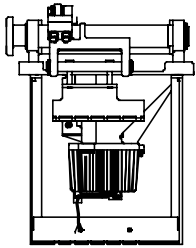

1056,0234  
**Antriebseinheit**  
 drive unit  
 unité d'entraînement

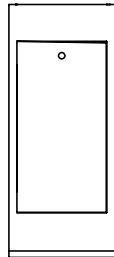

1045,0171  
**Gehäuse vormontiert**  
 housing  
 fût

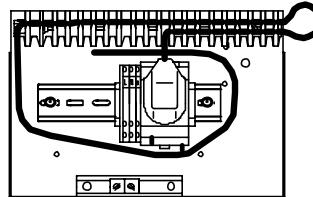

1031,5019  
**Anschlußeinheit**  
 supply unit  
 plaque support d'arrivée  
 d'alimentation

gelb  
 yellow  
 jaune



2036,0021

2036,0021  
**Zugfeder, stark**  
 spring, strong  
 ressort, fort

2036,0022  
**schwach**  
 weak  
 faible



2018,0332  
**Firmenschild**  
 name-plate  
 plaque signalétique

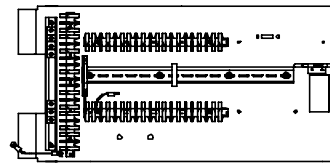

1031,5020  
**Montageplatte**  
 mounting plate  
 plaque support de commande

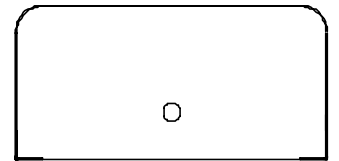

2029,0023  
**Haube**  
 hood  
 capot



1031,0097  
**Befestigungssatz**  
 ancor-set  
 kit de fixation



2043,0100  
**U-Profil**  
 U-rail  
 U-profil



2069,5006  
**Klammer**  
 plastic-clamp  
 clavette



3466,0019  
**Schlüssel**  
 key  
 clé



3576,0043  
**Verschlussstopfen**  
 rubber-cap  
 capuchon



3468,0028  
**Schloß**  
 lock  
 serrure

1056,0234

Antriebseinheit

drive unit

unité d'entraînement

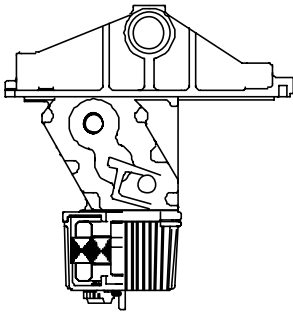
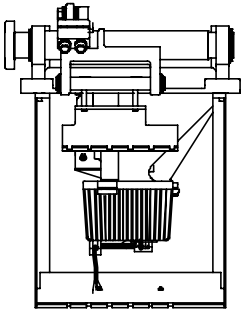

1064,0003 -  
Getriebeeinheit  
gear unit  
unité d'entraînement

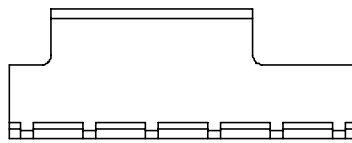

2047,5000  
Federtraverse oben  
upper spring fixture  
support supérieur de  
fixation de ressort

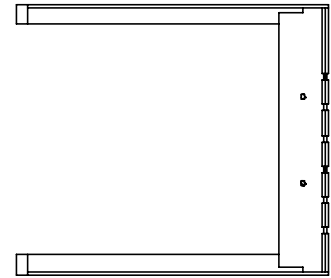

1071,5004  
Federtraverse unten  
lower spring fixture  
support inférieur de  
fixation de ressort

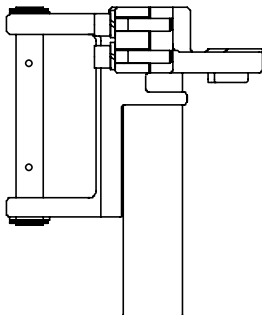

1018,5000  
Flanschhebel  
flange-lever  
levier d'entraînement

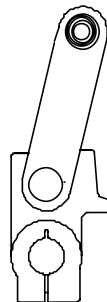

1018,5001  
Motorhebel  
motor lever  
levier de sortie réducteur



3004,0001  
Anschlagpuffer  
end stop  
butée caoutchouc

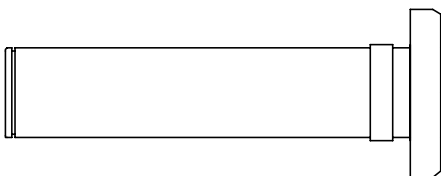

1014,0029  
Flanschrohr  
flange-shaft  
arbre porte flasque



3019,0055  
Ø23/20x21

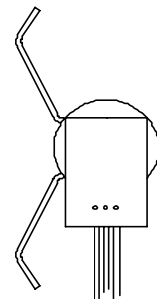

1031,0321  
Potentiometer  
potentiometer  
potentiometer

1064,0003

Getriebeeinheit

gear unit

unité d'entraînement

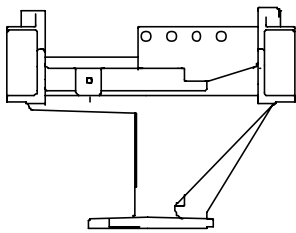
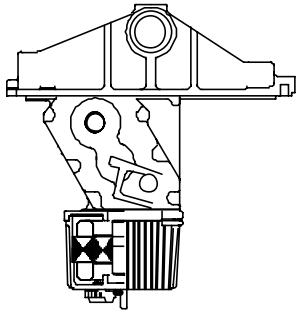

2060,5000  
Getriebegehäuse  
casting  
réducteur

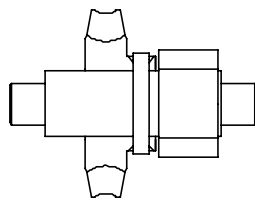

1003,0568  
Schneckenradwelle  
worm-gear  
pignon hélicoïdale

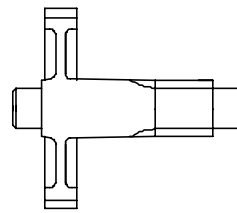

2044,0028  
Ritzelwelle  
end-shaft  
arbre de sortie



3232,0011  
Ø47/25x12

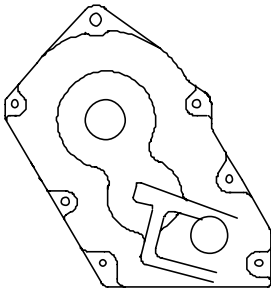

2011,5000  
Getriebedeckel  
gear cover  
carter du motoréducteur

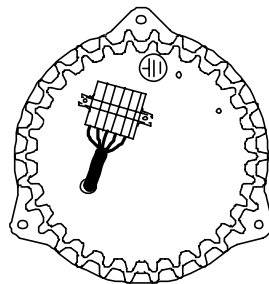

1084,0003  
Stator  
stator  
stator



3232,0062  
Ø26/10x8



3019,0054  
Ø44/40x30

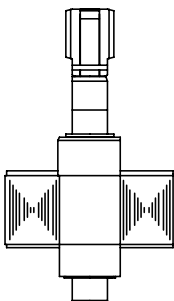

1003,0598  
Rotor  
rotor  
rotor

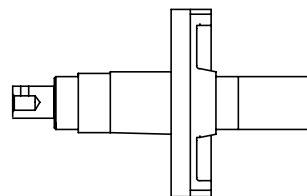

2044,5002  
Zahnradwelle  
gear-wheel  
pignon réducteur



3232,0022  
Ø35/15x11

1045,0171

Gehäuse vormontiert

housing

fût

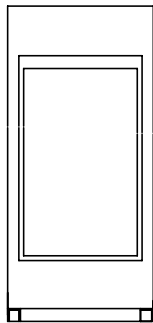
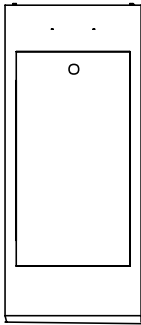

2061,0070  
Gehäuse  
housing  
fût



2043,0152  
Türe  
door  
portillon

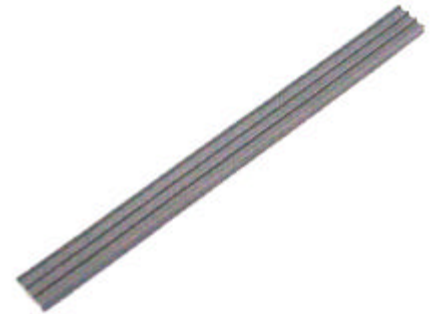

3224,0020  
Dichtung  
seal  
joint



3468,0028  
Schloß  
lock  
serrure



3004,0005  
Puffer  
damper  
amortisseur



3147,0011  
Kantenschutz  
edge protection  
bande de protection



2065,0004  
Kantenschutz  
edge protection  
bande de protection